

# LED Shapeable and Zoomable Track Light VG4510-2035

## User Manual

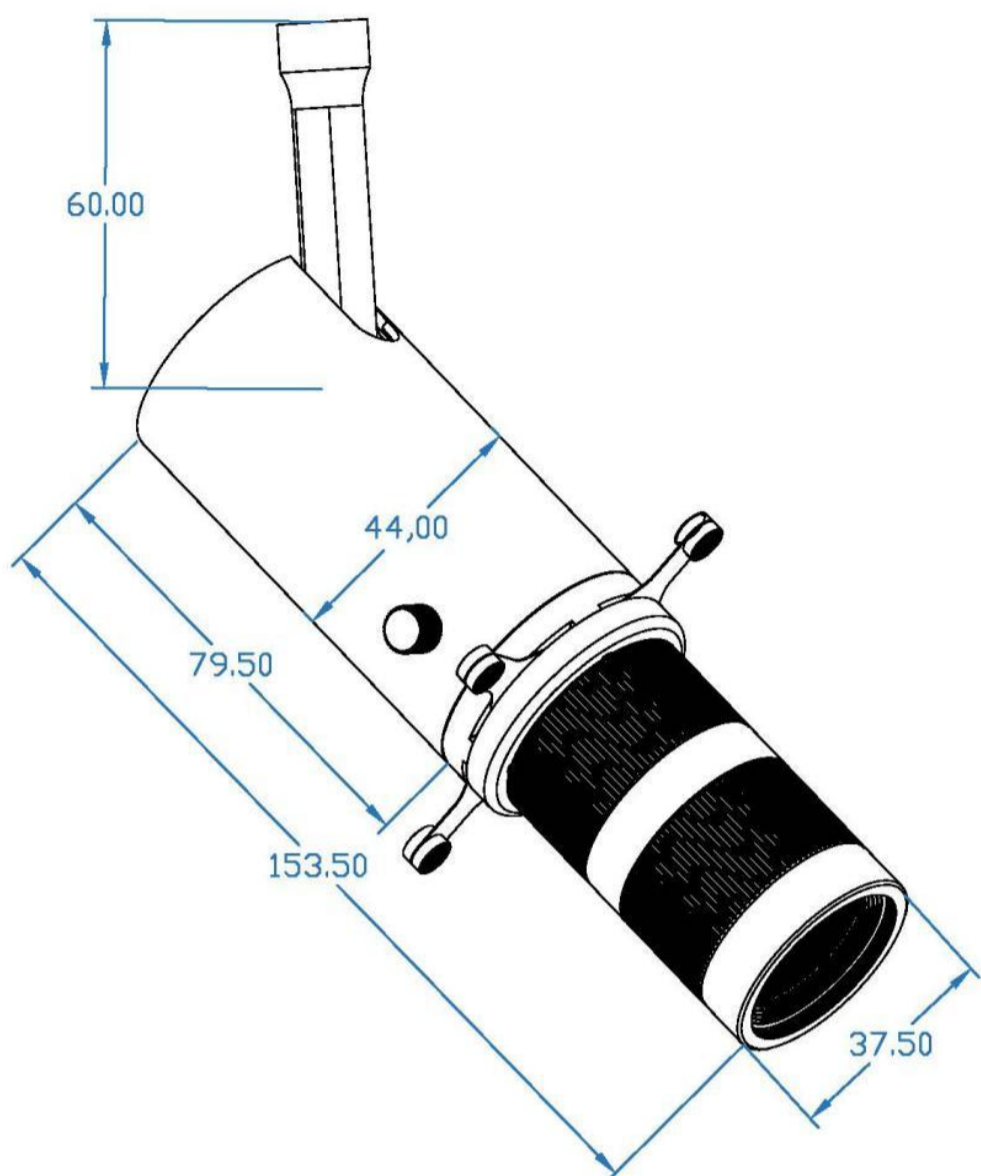

### Attention

In order to make the product installed correctly, please read this instruction carefully and keep it properly for further reference.

### Applications

This product is widely used for calligraphy, paintings and antiques in museums, art galleries, exhibitions, shopping malls, home, etc.,

### Functions

Shapeable / Zoomable / Projection / Smart Control

### Specifications

Product Name:	VANGO Shapeable and Zoomable Track Light	Power	10W
Item No.	VG4510-2035	Color	Black / White
Colour Temperature:	2700K/4000K/6000K	Weight	0.4kg
Luminous Flux	600-700LM	Filter Specification	37mm
Color Rendering Index(Ra)	Ra≥95	Beam Angle	25-35°

### Components and Parts

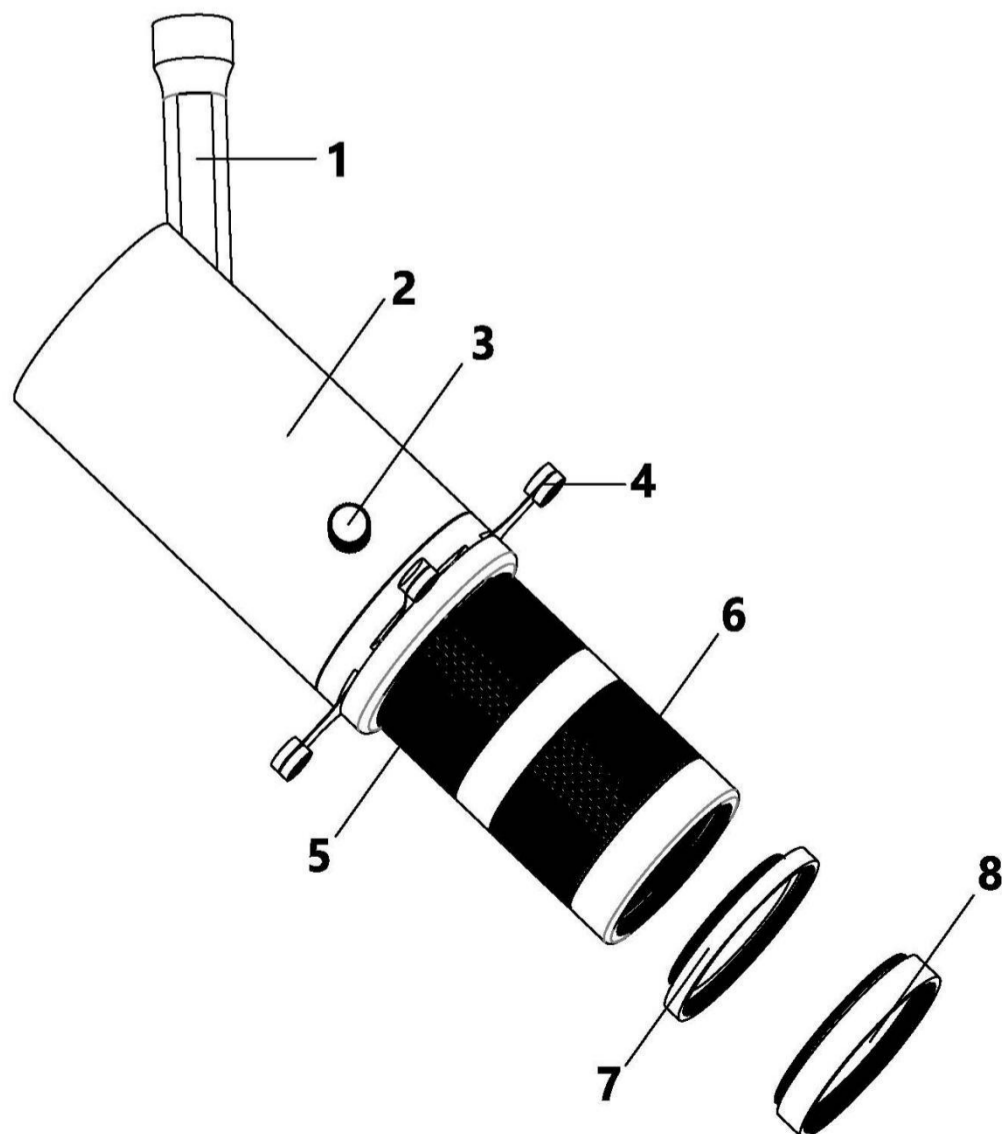

1. Holder
2. Cold Forging Heat Dissipation Body
3. Hand Screw
4. Diaphragm plates
5. Focus Knob
6. Zoom Knob
7. D32-37 Adapter Ring
8. Lens Cap

### Shapes and Size

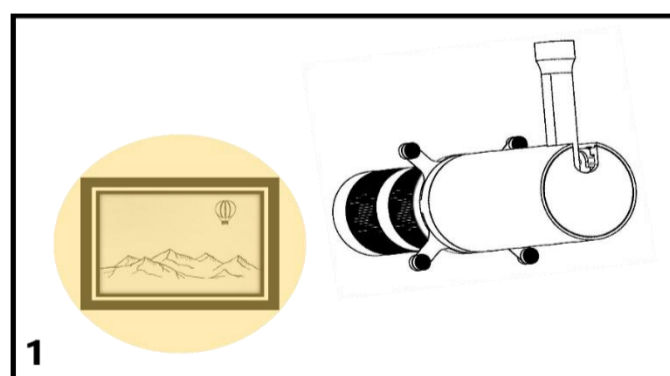

1. Adjust the aperture to the right size and point it directly at the center of the illuminated object to adjust the sharpness of lens to the right degree, as shown in Figure 1.

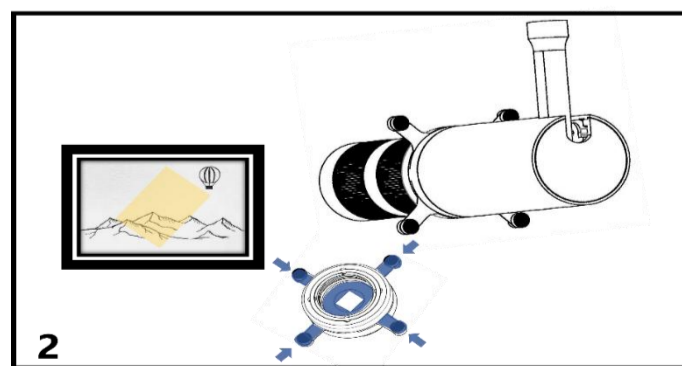

2. Push the four diaphragm plates outward to the maximum, and push them inward one by one, please ensure the square spot is smaller than the illuminated object, then adjust the aperture sharpness, as shown in Figure 2.

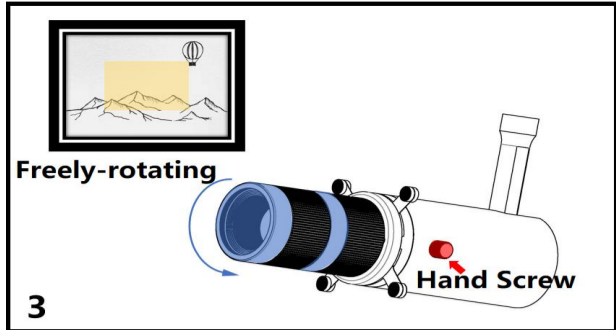

3.If the light spot does not match the shape of illuminated object, please loosen the hand screw(the red mark), rotate the lens(the blue mark), adjust the edge of light spot to be parallel to the illuminated object,and finally tighten the hand screw to fix the lens.This operation is also suitable for adjusting the LOGO projection direction, as shown in Figure 3.

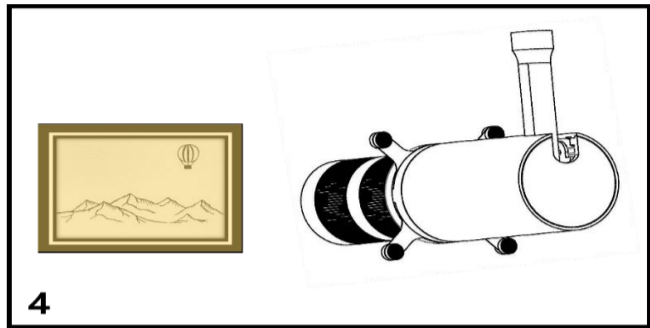

4.Pull the diaphragm plates outward one by one until the size of spot is the same as the illuminated object. You may need to repeat the above operations to get the satisfactory effect.

### Projection Function

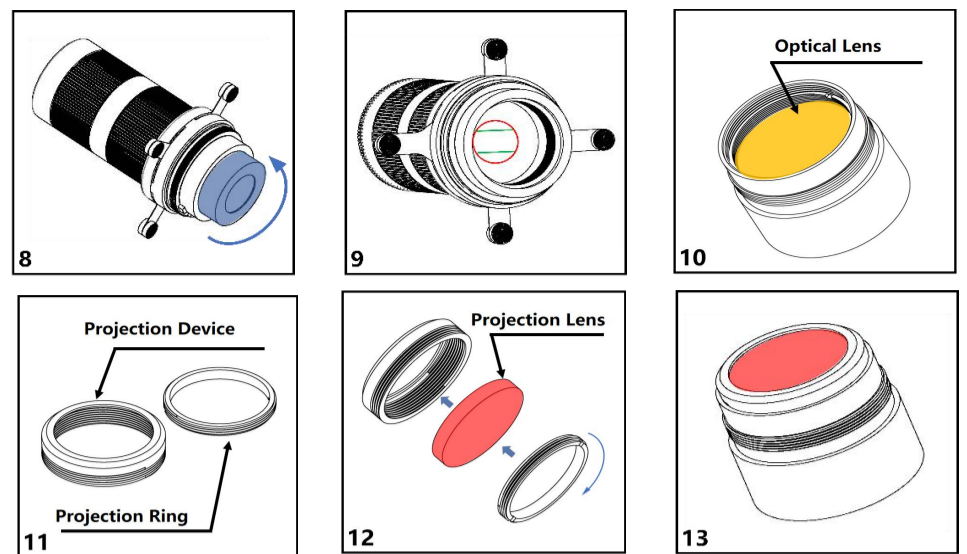
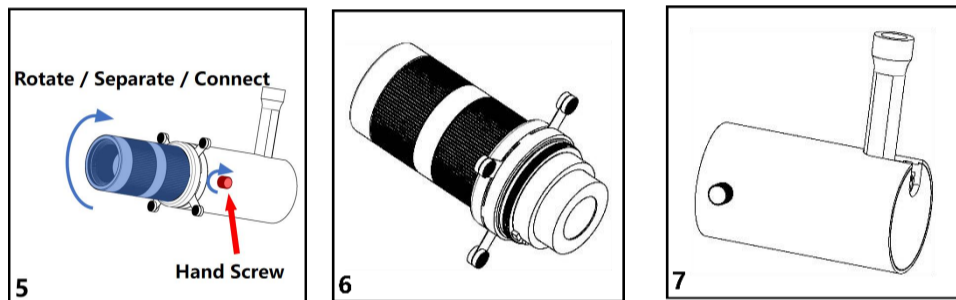

1.Loosen the screw first, then rotate and separate the main part of the lens (blue area) from the lamp body as shown in Figure 5. Figure 6 shows the separated optical lens,and the Figure 7 shows the separated lamp body.  
2.Unscrew the optical component at the bottom of the lens in Fig.8 , and separate into Figure 9 and Figure10.  
3.Please find the projection device provided by the manufacturer as shown in Finger 11, install the projection device as shown in Figure 12, and reinstall the optical lens as shown in Figure 10, the Figure13 is the finished effect , and then install it ( Figure 13 ) back to the lens(Figure 8 ).Finally ,install the whole lens back to the lamp body ( Figure 5)and tighten the screw.  
4.You can design varies image projection , specifications are shown in Figure 14.

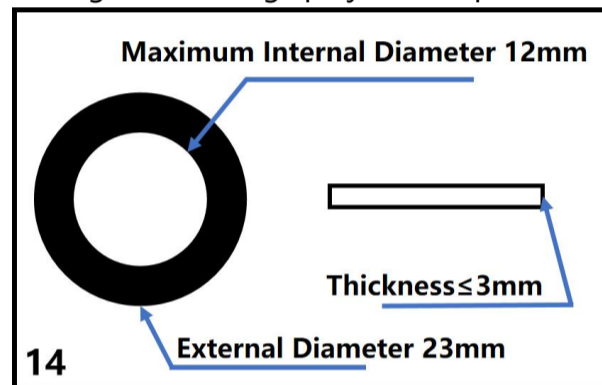

### Filter Function

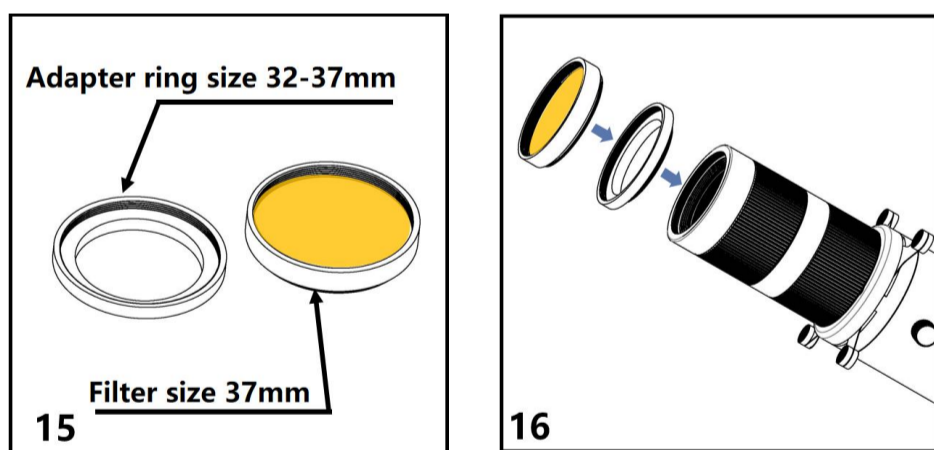

1. Please purchase the Diameter 37mm filter according to your requirement.  
2. Please rotate and connect the 37mm filter with the lamp body as shown in Figure 16.

### Daily Maintenance

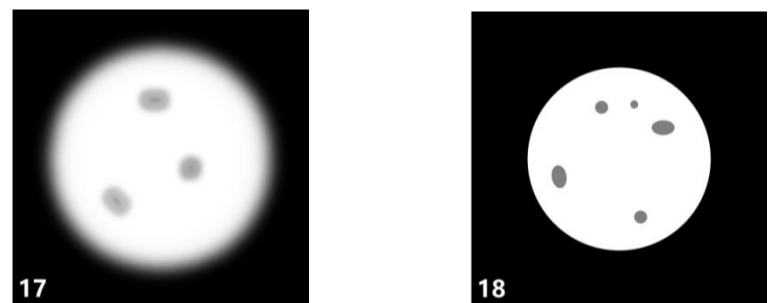
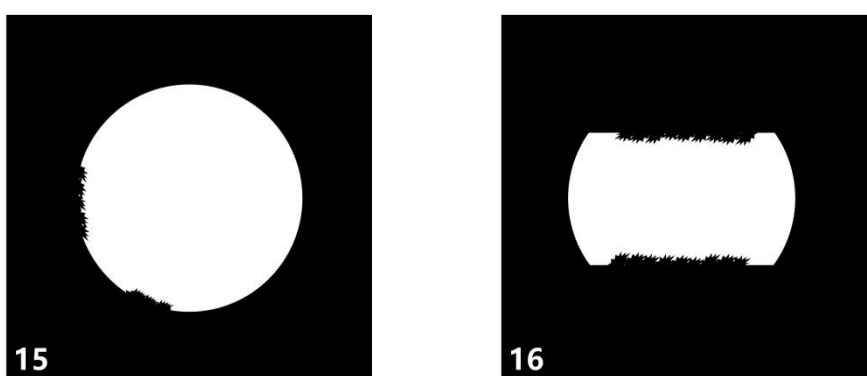

1. If the edge of the circular spot becomes rough or graininess(as shown in FIG.15) , please open the lens and wipe the red area as shown in FIG.9 with a dustless cloth or glasses cloth.  
2. If the edge of the square spot becomes rough or graininess(FIG. 16)please open the lens and wipe the green area as shown in FIG. 9 with dust-free cloth or glasses cloth.  
3.If the small shadows or the granules appear in the middle or the edge of any spot(FIG. 17 and FIG. 18),please open the lens and wipe the area shown in FIG. 10. with dust-free cloth or glasses cloth.

### Attention

- All the lens are made of optical glasses,please handle with care in using and handling to avoid the damage.
- Do not disassemble other parts of the lens except for replacing the projection device and routine lens maintenance.If the lens cannot be used normally due to artificial disassembly,we cannot provide the maintenance and quality assurance service.
- The weight of the whole lamp is around 1.40kg, ensure that the installation position bears enough weight and the installation environment is safe and reliable.
- The lens does not include any repair accessories,please do not disassemble the lens,if disassembled without permission will not be repaired or replaced.
- Please ensure the the focus lens (Figure 8) is tightened to avoid locking of lens.